



Addendum No. 3

DATE: October 11, 2017

TO: ALL PLANHOLDERS OF THE GALVAN PARK HANDBALL COURT
IMPROVEMENTS PROJECT

FROM: YAT CHO – CITY OF MORGAN HILL PROJECT ENGINEER 

RE: Clarification

Page(s) 2.

1. Replace the plan sheets (L2.1) with the attached revised plan sheets (L2.1R)).
2. The Galvan Park Handball Court Walls shall be cast in place concrete walls as per structural drawings.

ADDENDUM ACKNOWLEDGMENT

Bidder acknowledges receipt of this addendum, which shall be attached to the proposal.

Contractor's Representative

Date

THIS DOCUMENT SHALL BECOME A PART OF THE PROJECT SPECIFICATIONS

Page 1 of 1

DEMOLITION NOTES

1. THE CONTRACTOR SHALL PERFORM ALL CLEARING, DEMOLITION, SITE PREPARATIONS AND REMOVAL OF OBSTRUCTIONS NECESSARY FOR THE PROPER EXECUTION OF ALL WORK CONTAINED IN THE CONTRACT DOCUMENTS.
2. THE CONTRACTOR SHALL VISIT THE SITE PRIOR TO BID SUBMITTAL TO DETERMINE THE EXACT EXTENT AND DEPTH OF SITE DEMOLITION REQUIRED AND VERIFY COMPLIANCE WITH DRAWINGS. THE OWNER'S REPRESENTATIVE SHALL BE NOTIFIED IMMEDIATELY OF ANY DISCREPANCIES.
3. THE CONTRACTOR SHALL VERIFY THE LOCATIONS OF ALL EXISTING UTILITIES, STRUCTURES, AND SERVICES BEFORE COMMENCING WORK. THE LOCATIONS OF UTILITIES, STRUCTURES, AND SERVICES SHOWN IN THE CONTRACT DOCUMENTS SHALL BE DEEMED TO BE APPROXIMATIONS ONLY. ALL DISCREPANCIES BETWEEN WHAT IS SHOWN AND THE ACTUAL FIELD CONDITIONS SHALL BE REPORTED TO THE OWNER'S REPRESENTATIVE. THE CONTRACTOR SHALL CONTACT UNDERGROUND SERVICE ALERT (USA) AT (800) 227-2600 PRIOR TO ANY DEMOLITION OR EXCAVATION. UPON COMPLETION OF USA MARKING OPERATIONS, THE CONTRACTOR SHALL RECORD ALL UTILITY MARKINGS ON A SEPARATE SET OF DRAWINGS AND BE PROVIDED TO OWNER AT COMPLETION OF CONSTRUCTION. THIS SET SHALL BE KEPT ON-SITE FOR REFERENCE FOR DURATION OF CONTRACT. NOTIFY THE OWNER IMMEDIATELY SHOULD CONFLICTS ARISE, AND REDIRECT WORK TO AVOID DELAY.
4. ALL EXISTING ITEMS ARE TO REMAIN UNLESS OTHERWISE NOTED. THE CONTRACTOR SHALL BE RESPONSIBLE FOR REPAIRING OR REPLACING, AT CONTRACTOR'S EXPENSE, ANY EXISTING ITEM DAMAGED OR DESTROYED BY CONSTRUCTION OPERATIONS. THE CONTRACTOR SHALL ALSO BE RESPONSIBLE FOR REPAIRING OR REPLACING ANY AND ALL DAMAGES TO ADJACENT PROPERTIES. THE DAMAGED ITEMS SHALL BE RESTORED TO AN "AS-WAS" OR BETTER CONDITION OR REPLACED PER THE DISCRETION OF THE OWNER.
5. PRIOR TO ANY DEMOLITION WORK, THE CONTRACTOR SHALL INSTALL SELF-SUPPORTING INTERLOCKING CHAIN-LINK TEMPORARY CONSTRUCTION FENCING TO ENCLOSE AND SECURE THE PROJECT AREA. LIMIT OF WORK. THE FENCING SHALL CONTAIN PEDESTRIAN AND/OR VEHICULAR ACCESS GATES AS NECESSARY AND SHALL BE MINIMUM SIX (6) FEET HIGH, WITH A TOP AND BOTTOM RAIL KNUCKLED TOP AND BOTTOM SELVAGE (NO BARBED WIRE PERMITTED). THE CONSTRUCTION FENCING WORK SHALL BE SUBJECT TO THE DISCRETION OF THE OWNER.
6. PRIOR TO ANY DEMOLITION WORK, THE CONTRACTOR SHALL PROTECT ALL EXISTING PLANT MATERIALS NOT SCHEDULED FOR REMOVAL BY INSTALLING TEMPORARY FOUR (4) FOOT HIGH "BLAZE ORANGE" CONSTRUCTION SAFETY FENCING AT THE TREE DROP LINES OR THE PERIMETER PERIMETER OF THE TREE GROUPINGS. THE FENCING SHALL BE SECURED WITH DRIVEN METAL STAKES. ALL TREE PROTECTION WORK SHALL BE SUBJECT TO THE DISCRETION OF THE OWNER.
7. THE CONTRACTOR SHALL PROVIDE THE REQUIRED COORDINATION OF ANY EXISTING UTILITY FOR ITS TEMPORARY DISCONNECTION, PROTECTION, REMOVAL AND/OR STORAGE AS MAY BE REQUIRED DURING CONSTRUCTION. THE CONTRACTOR SHALL COORDINATE WITH THE OWNER TO DETERMINE WHETHER TEMPORARY SERVICES ARE NECESSARY.
8. DEMOLITION SHALL INCLUDE THE REMOVAL OF DESIGNATED HARDSCAPE ITEMS AND ANY FOUNDATION, BASE MATERIAL OR STRUCTURAL SUPPORT RELATED TO THE ITEM. FOR PLANT MATERIAL THIS SHALL INCLUDE STUMPS AND ROOTS OVER TWO (2) INCHES IN DIAMETER. REMOVAL SHALL INCLUDE DISPOSAL OFF-SITE IN A LEGAL MANNER ACCEPTABLE TO THE OWNER AND IN COMPLIANCE WITH ALL FEDERAL, STATE, AND LOCAL CODES AND ORDINANCES.
9. LOCATION OF THE UNDERGROUND UTILITIES IS AN APPROXIMATION AND SHOULD BE FIELD VERIFIED BY THE CONTRACTOR.
10. ANY (B) UTILITIES TO REMAIN SHALL RECEIVE A NEW UTILITY BOX IF LOCATED WITHIN LIMIT OF WORK.

DEMOLITION LEGEND

SYM	DESCRIPTION
	LIMIT OF WORK
	EXISTING SURFACE VEGETATION TO BE REMOVED PER SPECIFICATIONS. EXISTING TOP SOIL SHALL BE REMOVED FROM SITE. REFER TO SPECIFICATIONS FOR INFORMATION. REMOVE EXCESS SOIL FROM SITE.
	EXISTING ASPHALT PAVING TO BE REMOVED.
	EXISTING CONCRETE TO BE DEMOLISHED AND REMOVED.
	CONSTRUCTION STAGING AREA
	DEMOLISH AND REMOVE EXISTING FENCE, INCLUDING GATES, POSTS, FABRIC AND FOOTINGS.
	SAWCUT EXISTING PAVING
	TREE TO REMAIN AND BE PROTECTED AND PRUNED, REFER TO SPECIFICATIONS

- ITEMS TO BE DEMOLISHED AND REMOVED**
- 1 EXISTING 1" PVC RISER TO BE CUT, CAPPED, AND REROUTED OFF SITE PER OWNER DIRECTION.
 - 2 EXISTING FENCE POSTS AND ASSOCIATED FOOTINGS ARE TO BE DEMOLISHED AND REMOVED WHILE ENSURING THE EXISTING CONDITION OF THE ADJACENT PAVING IS PROTECTED. CONTRACTOR TO REPLACE ANY PAVING DAMAGED DURING POST DEMOLITION AT CONTRACTOR COST.
 - 3 EXISTING FENCING AT FENCE POST IS TO BE REMOVED FROM FENCE POST AND ROLLED BACK TO NEXT FENCE POST. EXISTING FENCE POST IN EXISTING PAVING IS TO BE DEMOLISHED AND REMOVED. CONTRACTOR IS TO REPLACE FENCE POST WITH NEW FENCE POST, RECONNECT EXISTING FENCING AND PATCH EXISTING PAVING DAMAGED BY POST REMOVAL, PER MATERIAL/LAYOUT PLAN SHEET 1&1.

- ITEMS TO BE PROTECTED OR RELOCATED**
- A EXISTING TRASH ENCLOSURE IS TO REMAIN AND BE PROTECTED IN PLACE.
 - B EXISTING GATE IS TO REMAIN AND BE PROTECTED IN PLACE.
 - C EXISTING DOWNSPOUT AND ASSOCIATED DRAIN INLET TO REMAIN AND BE PROTECTED IN PLACE.

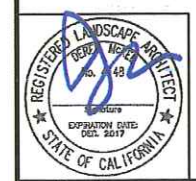
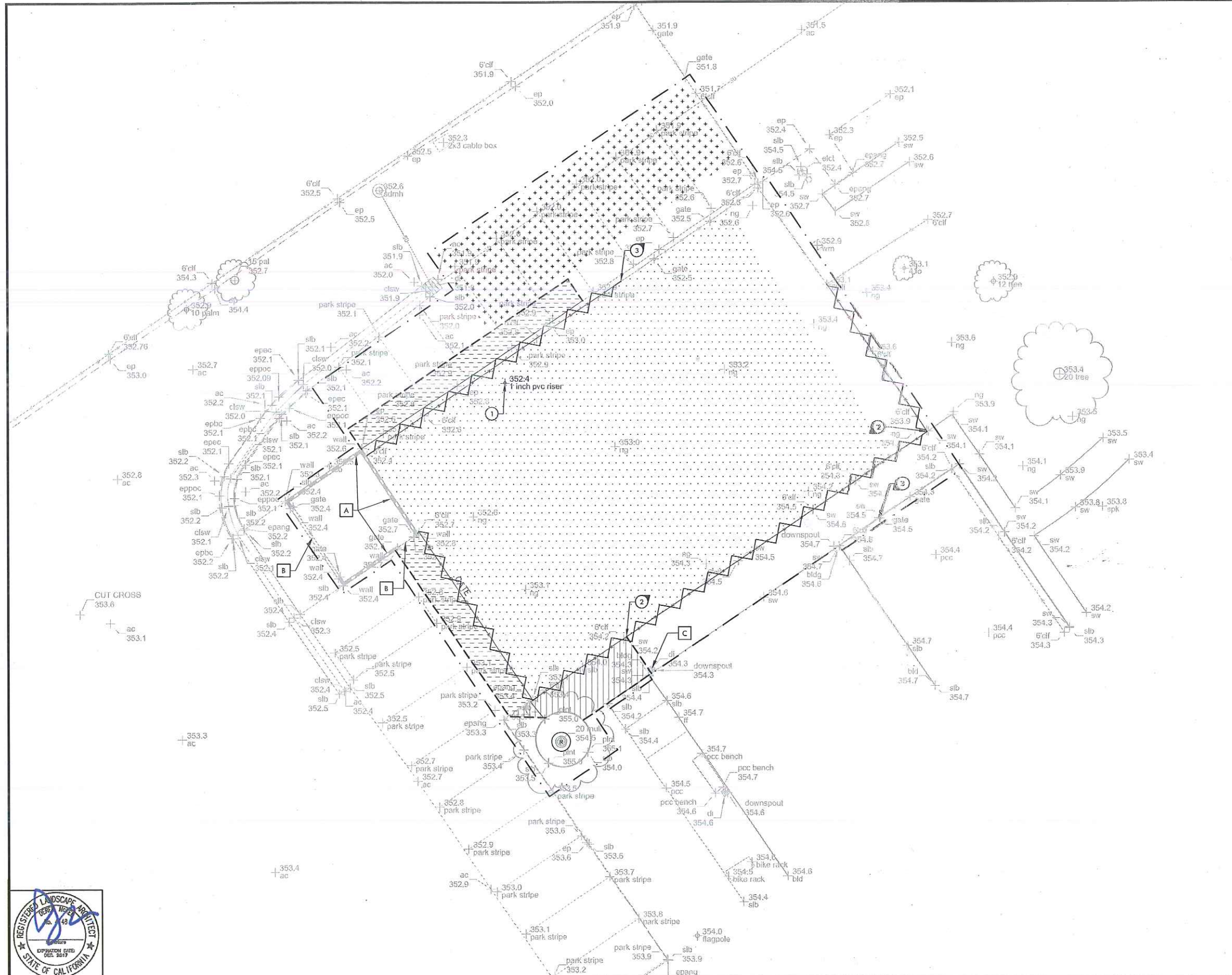
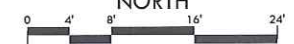

<p>WORK ACCEPTED: _____ INSPECTOR: _____</p>		<p>DRAWN: NT DESIGN: VERDE HOR: N/A</p>		<p>CHECKED: DM VER: N/A</p>		<p>APPROVED: _____ DATE: _____</p>		<p>NO. _____ DESCRIPTION _____ DATE _____ BY _____</p>		<p>Revisions _____</p>	
<p>KARL B. BLANK - CITY ENGINEER RCE 35416 EXP. 12/31/2017</p>		<p>City of Morgan Hill Public Works Department 17575 Peak Ave. Morgan Hill, CA 95037 (408)778-6480, Fax (408)778-7235</p>		<p>LANDSCAPE ARCHITECTURE CIVIL ENGINEERING SPORT PLANNING & DESIGN 2445 The Alameda, Ste. 200 San Jose, CA 95126 Tel: 408.983.7200 Fax: 408.983.7299 www.verdegroup.com</p>		<p>W. MAIN AVE. AND HALE AVE., MORGAN HILL, CA 95037</p>		<p>DEMOLITION PLAN GALVAN PARK HANDBALL IMP.</p>		<p>FILE NUMBER: 1603000 PRINT DATE: 09/21/17 SHEET NUMBER: L21R</p>	

100% SUBMITTAL